

# TS-3

Bellows type

The TS-3 radiator trap, same as TS-1, is bellows thermostatic type and supports a working pressure of up to 0.2MPa. It is used for a wide variety of heating equipment.

## ■Features

1. Compact, lightweight and reduced noise.
2. Prevents freezing damage since designed not to allow condensate to remain inside.
3. Quickly discharges cold condensate and air at the start of operation.
4. The valve and valve seat are made of stainless steel. Fluororesin is used for the cover gasket, making disassembly and assembly easy.

## ■Specifications

Application		Steam condensate
Working pressure		0.01-0.2 MPa
Maximum temperature		135°C
Material	Body	Bronze
	Valve	Brass
	Valve seat	Stainless steel
	Thermoelement	Phosphor bronze
	Union	Brass
Connection		Inlet: JIS R screwed (union joint) Outlet: JIS Rc screwed

\* Recommend model TS-1H for 25A of maximum working pressure 0.2 MPa.

## ■Dimensions (mm) and Weights (kg)

### · TS-3A

Nominal size	d	L	H <sub>1</sub>	H <sub>2</sub>	Weight
15A	1/2	80	35	74.5	0.5
20A	3/4	87	41	76.5	0.6

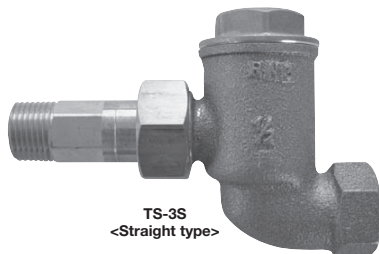
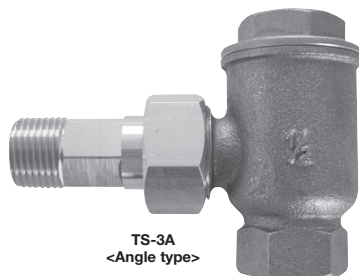
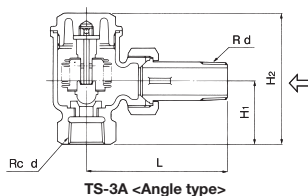

## · TS-3S

Nominal size	d	L <sub>1</sub>	L <sub>2</sub>	L <sub>3</sub>	H <sub>1</sub>	H <sub>2</sub>	Weight
15A	1/2	85	38	123	28	67.5	0.5
20A	3/4	94	41	135	34	69.5	0.7

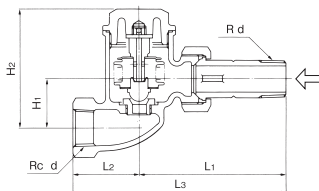

TS-3S &lt;Straight type&gt;

## ■ Maximum Continuous Discharge Capacity Chart

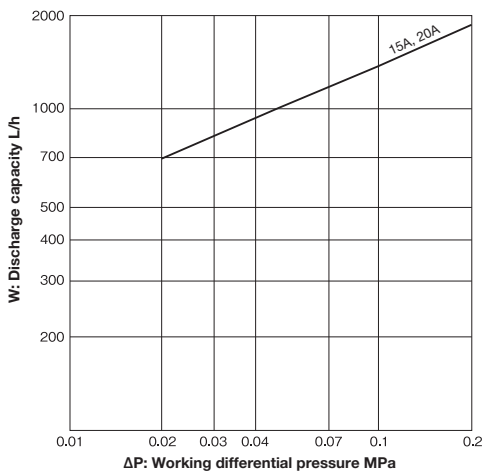

· This chart shows the maximum discharge. In designing a system, set a sufficient safety factor (two or three times).